



NESSCAP® Ultracapacitor Products

Features

- EDLC(Electric Double Layer Capacitor)
- Weldable terminals
- Ultra low internal resistance
- Highest power performance available



Dimension

Dimension in mm (not to scale)

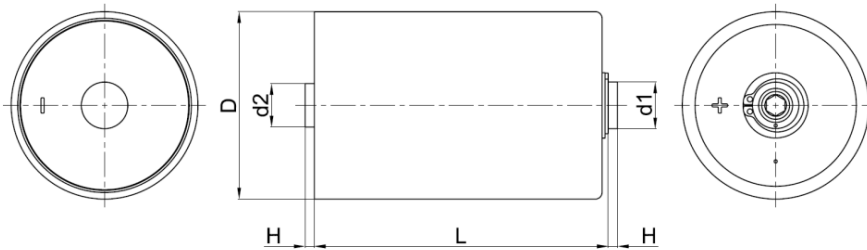

Capacitance (F)	Dimension (mm)				
	D (±0.2)	L (±0.3)	H (±0.125)	d1 (0/-0.05)	d2 (0/-0.05)
1600	60.2	85.0	3.0	14.9	14.0

Product & Spec.

Rated Capacitance (F)	Internal Resistance (mΩ)		Max. Current (A)	Leakage Current (mA)	Stored Energy (Wh)	Specific Energy (Wh/kg)	Nominal Weight (g)	Part Number
	AC(100Hz)	DC						
Discharge with constant current at 25°C			1 sec discharge rate to 1/2V _R	72hours, 25°C	at V _R	Gravimetric		
1600	< 0.34	< 0.41	1,304	< 3.00	1.620	4.84	335	ESHSR-1600C0-002R7A5

Rated Voltage, V _R	2.7 V	
Surge Voltage	2.85 V	
Capacitance Tolerance	0% / +20%	
Operating Temperature Range	-40 ~ 65 °C	ΔC < 5% and ΔESR < 50% of initial value measured at 25°C
Storage Temperature Range	-40 ~ 70 °C	
Life Time at RT ⁽¹⁾	10 years	(1) ΔC < 30% and ΔESR < 150% of specified value, respectively and LC < specified value (2) Cycled between rated voltage and half rated voltage under constant current at 25°C
Cycle Life (25°C) ⁽¹⁾⁽²⁾	1,000,000 cycles	

* Life time is a provisional value

© NESSCAP 2009. All Rights reserved. Design, Specifications are subjected to change without notice.